



# Tree Removal Contract

## Parties

This **Tree Removal Contract** ("**Contract**" hereinafter) has been signed by and between the parties below, with respect to the removal of the trees located in the Client's premises;

**The Contractor**

**The Client**

## Term and Conditions

### 1. The Premises

The address of the premises where the tree removal services will be performed is as follows;

---

---

### 2. Schedule

The work of tree removal shall commence on \_\_\_\_\_ and shall be completed including cleaning and disposal of the garbage, by \_\_\_\_\_. At least \_\_\_\_\_ workers, one of which is a coordinator, will participate in the work and each worker will work at least \_\_\_\_\_ hours a day. The working principles of the workers are determined by the coordinator.

The completion date may be subject to reasonable adjustments due to unfavorable weather conditions or unforeseen circumstances that may affect the safety of the workers and efficient completion of the work. The parties shall promptly communicate and agree upon any necessary changes to the schedule in such cases.

### 3. Price and Payment Schedule

The total price of the services to be provided under this Contract is \_\_\_\_\_. This amount will be paid in two equal installments, half on the signing date of this Contract and half on the day the services are completed.

Payments shall be made via \_\_\_\_\_.

#### **4. Employment and Security**

The Contractor shall be responsible for ensuring that all employees who will be worked under this Contract are qualified and competent to perform their assigned tasks. The Contractor is solely responsible for all labor receivables of the workers. The Contractor shall comply with all applicable labor laws, including but not limited to minimum wage requirements, working hours, and workplace safety regulations.

The Contractor shall exercise reasonable care to protect the security and privacy of the Client's property, including but not limited to trees, structures, and surrounding areas.

#### **5. Disposal**

The Contractor shall be responsible for the safe and proper removal of all trees designated for removal under this Contract. The Contractor shall comply with applicable laws, regulations, and environmental guidelines while removing, disposing and shipping of the trees. Disposal methods may include, but are not limited to, recycling, chipping, mulching, hauling, or other lawful means as approved by the Client.

If the customer stated that the removed trees were transferred to another place and planted, the contractor is obliged to ensure the trees are being duly removed and prevent them from being damaged.

#### **6. Equipment**

The Contractor shall provide all necessary equipment, tools, and machinery required for the safe and efficient execution of tree removal services under this Contract. The Contractor shall also ensure that all equipment meets industry standards and safety requirements.

The contractor may not exceed the contract period by claiming that the equipment is missing, broken or damaged.

#### **7. Independent Contractors**

It is expressly agreed that the Parties shall be independent contractors and that the relationship between the Parties shall not constitute a partnership, joint venture or agency. Neither Party shall have the authority to make any statements, representations or commitments of any kind, or to take any action, which shall be binding on the other Party, without the prior consent of such other Party.

## 8. Other Provisions

**Confidentiality** - The terms and conditions contained in this Contract shall constitute confidential information. The Parties hereto undertake and agree to keep confidential the confidential information to any third party without the written consent of the other party.

**Non-Waiver** - The failure of any of the Parties to insist on the strict compliance with any of the terms of this Contract shall not constitute a waiver or relinquishment of any rights of said Party hereto. No waiver by either Party shall be considered as having been made unless made in writing and signed by the waiving party.

**Separability Clause** - Should any provisions of this Contract be declared as invalid by any competent court, the same shall apply only to the said provision, and the rest of the remaining provisions hereof shall remain valid and enforceable.

**Modifications** - No amendments, changes, or modifications, shall be considered as having been made unless otherwise made in writing and signed by the parties hereto.

**Assignment** - Neither party may assign to transfer his or her rights and obligations under this Contract without the prior written consent of the other.

**Governing Law** - This Contract shall be construed and governed by the laws of the State of \_\_\_\_\_ and applicable Federal laws, to the exclusion of other states. Any dispute arising from this Contract shall be determined by the courts in the State of \_\_\_\_\_.

### The Contractor

Name

Date

Signature

---

### The Client

Name

Date

Signature

---

Thanks for using **Tree Removal Contract!** To edit this PDF with **Jotform Sign**, sign up for a free Jotform account today.

[EDIT PDF](#)

## Learn More About Jotform PDF Products

Jotform offers powerful PDF solutions. Check them out below.

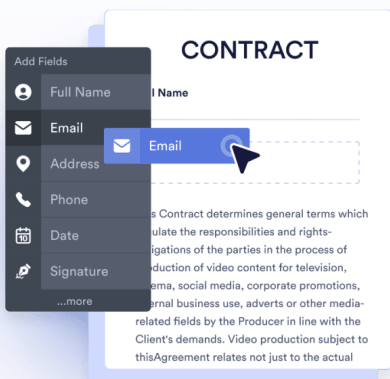

### JOTFORM PDF EDITOR

Turn form submissions into PDFs automatically — ready to download or save for your records.

[Go to PDF Editor >](#)

### SMART PDF FORMS

Convert your PDF files into online forms that are easy to fill out on any device.

[Go to Smart PDF Forms >](#)

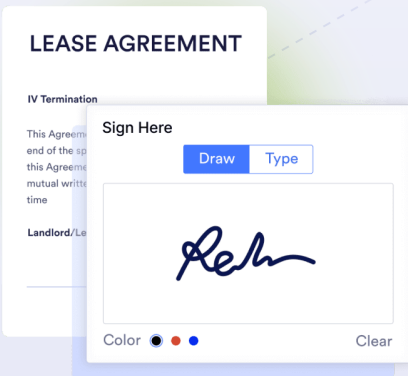
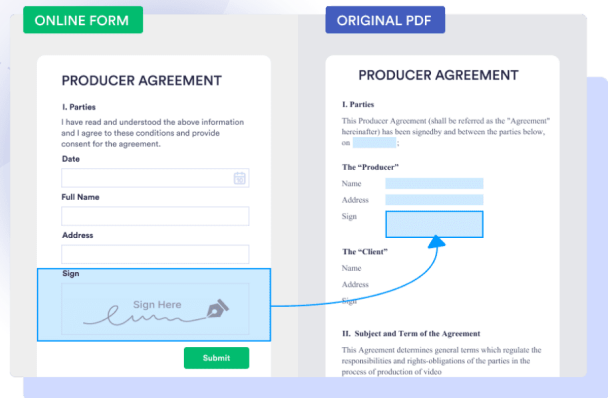

### JOTFORM SIGN

Collect e-signatures with Jotform Sign to automate your signing process.

[Go to Jotform Sign >](#)

*These templates are suggested forms only. If you're using a form as a contract, or to gather personal (or personal health) info, or for some other purpose with legal implications, we recommend that you do your homework to ensure you are complying with applicable laws and that you consult an attorney before relying on any particular form.*