



**EDIT PDF**

You can edit this PDF for free with Jotform.

## Police Resignation Letter

**To**

**From**

To Whom It May Concern;

I am writing to formally announce my resignation from my position as \_\_\_\_\_ in  
Department of \_\_\_\_\_ effective on \_\_\_\_\_.

After \_\_\_\_ years of serving my Department, I believe it is time for me to pursue new opportunities and challenges in my career. I have greatly valued my time at the Department and the experiences, skills, and relationships I have gained during my career.

In my remaining time with the force, I would be happy to help in assisting with the transition and train those who are willing to take over my duties and shifts.

I would like to thank you for the guidance, privileges, and mentoring you have provided during these past few years. I appreciate all the opportunities given to me to serve the community. It has likewise been a great honor to work alongside officers like yourself.

Sincerely,

**Name**

**Date**

**Signature**

---



Thanks for using **Police Resignation Letter!** To edit this PDF with **Jotform Sign**, sign up for a free Jotform account today.

[EDIT PDF](#)

## Learn More About Jotform PDF Products

Jotform offers powerful PDF solutions. Check them out below.



### JOTFORM PDF EDITOR

Turn form submissions into PDFs automatically — ready to download or save for your records.

[Go to PDF Editor >](#)

### SMART PDF FORMS

Convert your PDF files into online forms that are easy to fill out on any device.

[Go to Smart PDF Forms >](#)

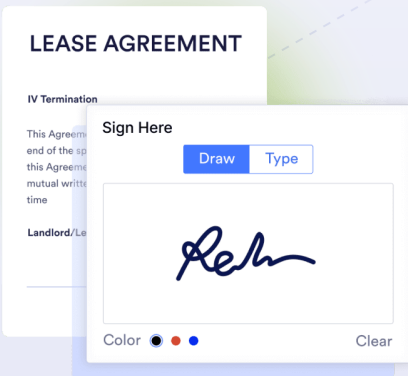
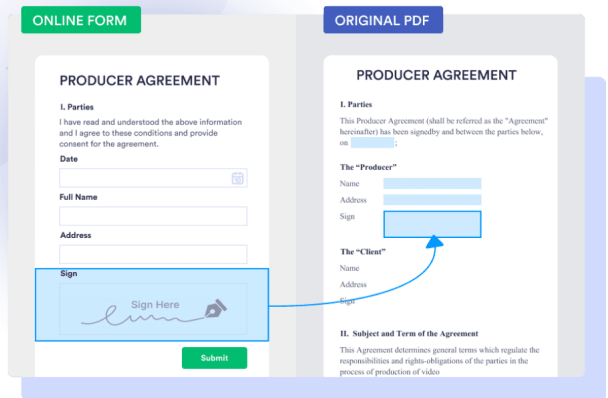

### JOTFORM SIGN

Collect e-signatures with Jotform Sign to automate your signing process.

[Go to Jotform Sign >](#)

*These templates are suggested forms only. If you're using a form as a contract, or to gather personal (or personal health) info, or for some other purpose with legal implications, we recommend that you do your homework to ensure you are complying with applicable laws and that you consult an attorney before relying on any particular form.*