



EDIT PDF

You can edit this PDF for free with Jotform.



UNITED STATES DISTRICT COURT
Angelina Heights District of Laguna

Complainant/s _____

=- versus -

Case No.: _____

Respondent/s _____

Judgement Letter

GREETINGS:

You are hereby notified that on _____, a Decision/Order/Resolution was rendered in the above-entitled case.

Pursuant to Article 223 of the Labor Code, as amended, and under Section 1, Rule IV of the 2011 National Labor Relations Commission Rules of Procedure, as amended, "Decisions, awards, or orders of the Labor Arbiter shall be final and executory unless appealed to the Commission by any or both parties within ten (10) calendar days from receipt thereof;

The decision of the Labor Arbiter in reinstating a dismissed or separated employee, insofar as the reinstatement aspect is concerned, shall immediately be executory, even pending appeal. The employee shall either be admitted bak to work under the same terms and conditions prevailing prior to his dismissal or separation or, at the option of the employer, merely reinstated in the payroll. The employer is likewise directed to submit a report of compliance within ten (10) calendar days from receipt of the Decision.

The posting of a bond by the employer shall not stay the execution for reinstatement.

No motion for reconsideration of this Decision shall be entertained.

Laguna, California, _____.

By the Authority of the Executive Labor Arbiter



Thanks for using **Judgement Letter!** To edit this PDF with **Jotform Sign**, sign up for a free Jotform account today.

[EDIT PDF](#)

Learn More About Jotform PDF Products

Jotform offers powerful PDF solutions. Check them out below.



JOTFORM PDF EDITOR

Turn form submissions into PDFs automatically — ready to download or save for your records.

[Go to PDF Editor >](#)

SMART PDF FORMS

Convert your PDF files into online forms that are easy to fill out on any device.

[Go to Smart PDF Forms >](#)

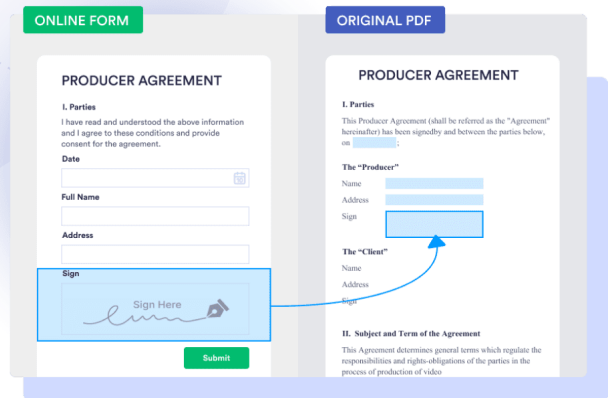

JOTFORM SIGN

Collect e-signatures with Jotform Sign to automate your signing process.

[Go to Jotform Sign >](#)

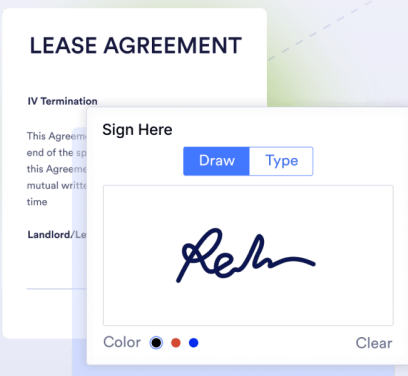

These templates are suggested forms only. If you're using a form as a contract, or to gather personal (or personal health) info, or for some other purpose with legal implications, we recommend that you do your homework to ensure you are complying with applicable laws and that you consult an attorney before relying on any particular form.