

Employee Equipment Agreement

Name

Position

Employee No.

Division and/or Department

Equipment Information

Make and Model

Serial No.

Additional Description

The Employer and the Employee agree that equipment indicated above is company-owned and the Employee shall use it only for work-related purposes. The Employee is responsible for the care and maintenance of the equipment. In case that the equipment is, in any case, damaged, lost, stolen, while outside the workplace, the Employee shall be responsible for the costs and expenses for equipment's replacement. In case the equipment gets broken due to wear and tear, the Employee shall report it to the Employer's IT department as soon as possible.

After the expiration and termination of the Employment Agreement between the parties, the Employee shall return the equipment to the Employer. If the Employee wants to purchase the equipment from the company, he/she shall notify the Employer to make a price offer. In absence of notice, the Employer has the right to withhold Employee's final pay until return of the equipment or that notice has been given.

By signing this Agreement, the parties acknowledge that the Employee has received the office equipment described above in working order and conforms to the terms and conditions for the use of the equipment.

Name

On behalf of

Date

Date

Signature

Signature



Thanks for using **Employee Equipment Agreement!** To edit this PDF with **Jotform Sign**, sign up for a free Jotform account today.

[EDIT PDF](#)

Learn More About Jotform PDF Products

Jotform offers powerful PDF solutions. Check them out below.

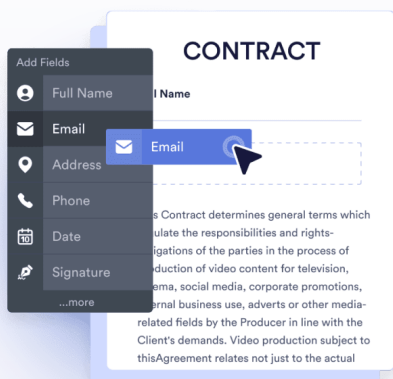

JOTFORM PDF EDITOR

Turn form submissions into PDFs automatically — ready to download or save for your records.

[Go to PDF Editor >](#)

SMART PDF FORMS

Convert your PDF files into online forms that are easy to fill out on any device.

[Go to Smart PDF Forms >](#)

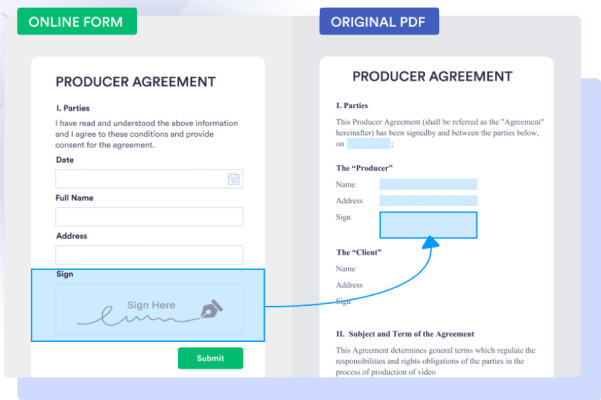

JOTFORM SIGN

Collect e-signatures with Jotform Sign to automate your signing process.

[Go to Jotform Sign >](#)



These templates are suggested forms only. If you're using a form as a contract, or to gather personal (or personal health) info, or for some other purpose with legal implications, we recommend that you do your homework to ensure you are complying with applicable laws and that you consult an attorney before relying on any particular form.