



EDIT PDF

You can edit this PDF for free with Jotform.

Electrical Service Contract

This Electrical Services Contract ("Contract") has been signed by and between the parties below;

Contractor

Client

Scope of Work - Within the scope of this Contract, the Contractor agrees to perform following services;

The Provider shall provide all necessary labor and all required materials to complete the these services in a professional manner and in accordance with industry standards.

Place of Work - The performance of this Contract shall be held on the premises located at

Timeline - Project timeline is as follws;

Phase	Scope	Due Date	Required Payment
Phase 1			
Phase 2			
Phase 3			
Phase 4			
Final Delivery			

Pricing and Payment - The Client agrees to pay _____ to the Contractor for the works within the scope of this Contract. A non-refundable initial payment of _____ shall be paid on the date of signature of this Contract. Balance amount shall be paid in accordance with the table above, upon the delivery of each phase.

If the Client fails to pay any of the installments, the Contractor may suspend service, or may terminate the Contract immediately.

The Contractor is solely responsible for all and any cost and expences of the labor. Workers cannot appeal to the Client for any receivables.

Warranties - The Contractor warrants that all electrical services shall be performed in a professional manner and in accordance with industry standards. The Contractor provides a _____ warranty on labor and workmanship, and a _____ warranty on materials and equipment used in the electrical services except for the situations caused by user error or acts of God such as earthquake, fire, flood, etc.

Termination - Either party may terminate this Contract with _____ days' written notice for any reason. In the event of termination, the Client shall compensate the Contractor for all completed work and expenses incurred up to the termination date.

Change Orders - Any change orders or modifications to the scope of work by the Client need to be requested from the Contractor in writing. The Contractor has right to reject such requests. Any changes or modifications, and additional costs or delays must be agreed in writing by both parties.

Independent Contractors - This Contract shall not render the Contractor an employee, partner, agent of, or joint venturer with the Client for any purpose. The Contractor is and will remain an independent contractor in their relationship to the Client.

Entire Agreement - This Contract constitutes the entire agreement between the parties with respect to the subject matter hereof and supersedes all prior agreements and understandings, whether written or oral, relating to such subject matter.

Governing Law - This Contract shall be governed by and construed in accordance with the laws of _____.

IN WITNESS WHEREOF, the parties hereto have executed this Contract as of the date of the last electronic signature below.

The Contractor

Name

Date

Signature

The Client

Name

Date

Signature



Thanks for using **Electrical Service Contract!** To edit this PDF with **Jotform Sign**, sign up for a free Jotform account today.

[EDIT PDF](#)

Learn More About Jotform PDF Products

Jotform offers powerful PDF solutions. Check them out below.

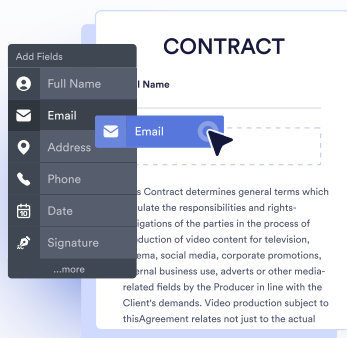

JOTFORM PDF EDITOR

Turn form submissions into PDFs automatically — ready to download or save for your records.

[Go to PDF Editor >](#)

SMART PDF FORMS

Convert your PDF files into online forms that are easy to fill out on any device.

[Go to Smart PDF Forms >](#)

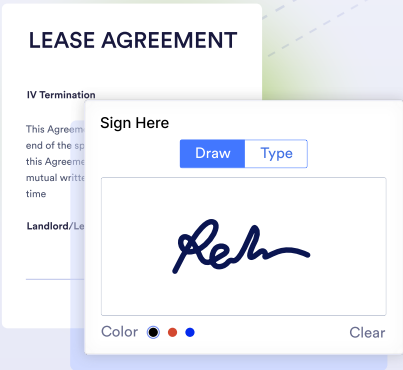
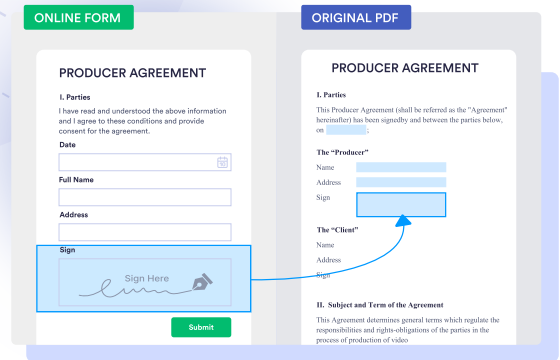

JOTFORM SIGN

Collect e-signatures with Jotform Sign to automate your signing process.

[Go to Jotform Sign >](#)

These templates are suggested forms only. If you're using a form as a contract, or to gather personal (or personal health) info, or for some other purpose with legal implications, we recommend that you do your homework to ensure you are complying with applicable laws and that you consult an attorney before relying on any particular form.